

Begin by cleansing the peristomal skin (area around the stoma) with mild soap and rinse with water. Soaps should be free of oils and creams. Remember that an oily substance on the skin may cause poor adhesion of the skin barrier. Pat dry thoroughly.



1

PREPARE AND APPLY THE SEAL

1. Warm the seal between your hands for approximately 30 seconds.

2a. Stretch to fit around the stoma

For some people, it's easier to apply the Eakin Cohesive® Seal directly to the skin. To apply the seal around your stoma, remove the release paper from both sides, mold, roll, stretch or compress the seal to any shape by gently stretching into shape. The seal may be cut and rejoined to fit around difficult sites.

2b. Position the seal on the body so that no skin directly around the stoma is exposed. Flatten the outer edge of the seal and hold in place for about 30 seconds to ensure it is secure*.

OR Apply directly to the pouching system

Some people find it simpler to apply the seal directly to their wafer/skin barrier or pouching system. To apply, remove release papers then mold to the desired shape directly on your wafer/skin barrier or pouching system.

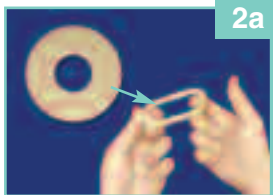

2a



2b

ANOTHER USE OF THE EAKIN COHESIVE® SEAL

Fill in uneven areas

3. There may be a need to fill in uneven peristomal skin to help prevent leakage. To apply, remove the release paper from both sides of the seal, break the seal into smaller pieces, and roll or mold. You can cut and rejoin the seal as necessary.

When the Eakin Cohesive® Seal is shaped, press it into your skin. Once the seal is in contact with your skin, you can gently smooth it or mold it further and achieve a custom fit.

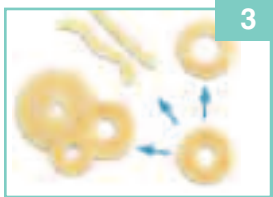

3

ATTACH YOUR POUCHING SYSTEM

4. **Two-Piece System:** If you have already placed the seal around your stoma, press the wafer to your skin and over the seal, then apply your pouch to the wafer. If you've applied the seal directly to the wafer, apply the wafer to your skin, then apply your pouch.

One-Piece System: If you have already placed the seal around your stoma, apply your pouching system over the seal. If you've applied the seal to your system, attach the pouching system to your skin.

Hold the pouch or wafer in position for a short time, to ensure the seal is secure*.



4



For more information on this product and others, call our Customer Relations Center (Registered Nurses on staff) at 1 800 465-6302, Monday through Friday, 8:00 AM to 6:00 PM (EST), or visit our Web Site at www.convatec.ca

*See package insert for complete instructions.