



# Results You Can Count On

Total confidence to accurately diagnose **Strep A pharyngitis**

Alere™ TestPack +Plus Strep A



# Testing with Confidence

Alere™ TestPack Strep A is the most suitable test for use in a primary care setting.<sup>1</sup>

.....

## **Pharyngitis is one of the most common reasons for visiting a doctor.**

Group A *Streptococcus* is the most common bacterial cause of pharyngitis but is often misdiagnosed resulting in the over prescribing of antibiotics, which can lead to an increase in antibiotic resistant strains of bacteria. Strep A pharyngitis, if not diagnosed and treated quickly can lead to significant health complications, such as glomerulonephritis and rheumatic fever.

This highly specific and sensitive Strep A test by Alere provides users with a rapid, clear '+' or '-' results and with the added benefit of unique on-board controls – **ensuring total precision in every test performed.**

Unlike other rapid tests which only incorporate a procedural control, **Alere™ TestPack +Plus Strep A** has built in positive and negative controls, giving complete confidence in the result every time.

# Precision You Can See

## Negative Control:

Indicates the possibility of an interfering substance, causing an invalid result.

## Plus/Minus Results:

Easy to read results.

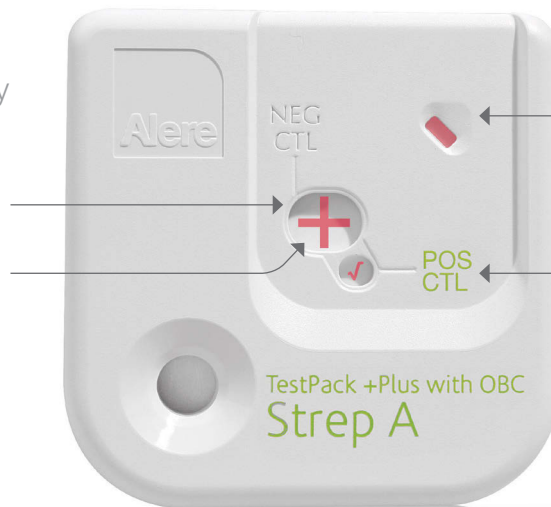

## End of Assay Indicator:

Informs the user when the results are ready to read.

## Positive Control:

Confirms that antibody detection is fully functional for both positive and negative test results.

# Easy Testing Process

The testing process for **Alere™ TestPack +Plus Strep A** is simple and can be done in four easy steps.

## 1. Add & mix Reagents with swab

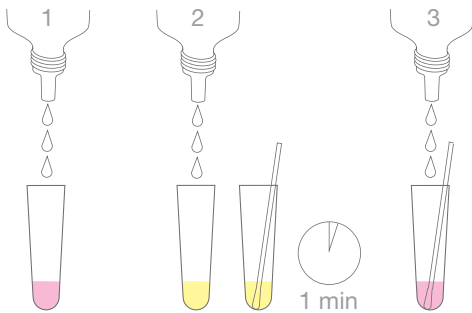

## 2. After squeezing, remove swab

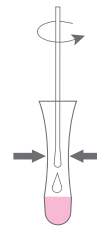

## 3. Dispense into sample well

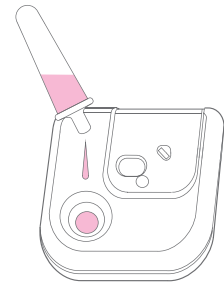

## 4. Read Test Results

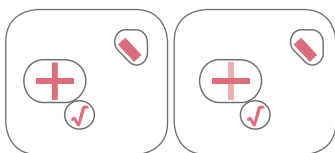

**Positive Test Result**

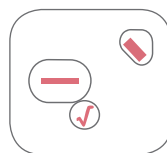

**Negative Test Result**

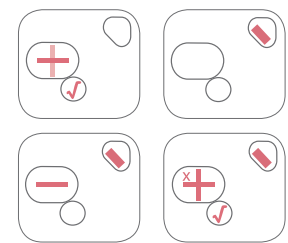

**Invalid Test Results**

# Accurate Results You Can Trust

Throat swabs were collected from children and adults presenting with symptoms of pharyngitis. Samples were cultured and tested with **Alere™ TestPack +Plus Strep A**.

Culture	Alere™ TestPack +Plus Strep A	
	+	-
+	122	3
-	4	240

The sensitivity of **Alere™ TestPack +Plus Strep A** was **97.6%** and the specificity was **98.4%** when compared to standard SBA culture.\*

## Alere™ TestPack +Plus Strep A Product Information

Catalogue No	505715J (20 Tests) 505796J (40 Tests)
Kit Size	20 or 40 Tests
Storage	2-30°C
Sample Type	Throat Swab
Time to result	Approximately 5 minutes
Sensitivity	97.6%
Specificity	98.4%



Distributed by:  
Alere International Limited  
Parkmore East Business Park  
Ballybrit Galway Ireland  
Tel: +353 (0) 91 771 880 | alere.com

1. Lasserter GM et al. In vitro evaluation of five rapid antigen detection tests for group A beta-haemolytic streptococcal sore throat infections. Fam Pract. 2009 Dec;26(6):437-44. Epub 2009 Sep 11.

\*Swabs were cultured on sheep blood agar (SBA).